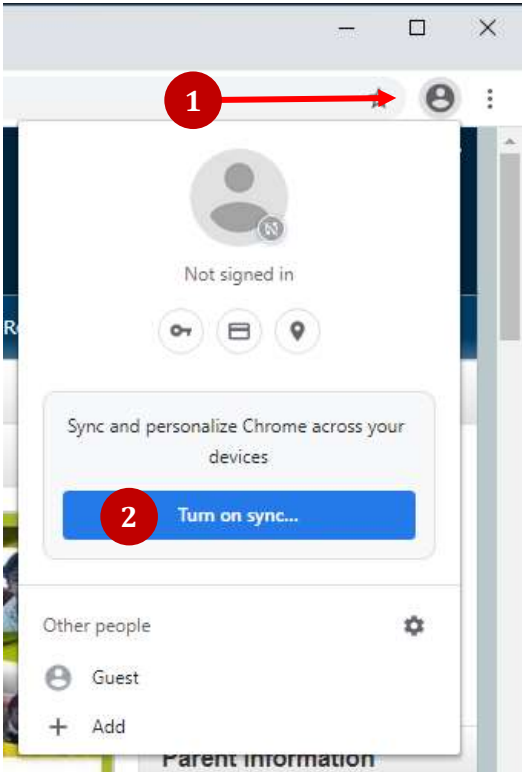

How to Create Your LFDCS Chrome Profile

Steps	Description	Screenshots
1.	<p>Launch Chrome.</p> <p><i>If you do not have the Chrome browser, download it here: https://www.google.com/chrome/ for iPhone/iPad for Android phones and tablets</i></p>	
2.	<p>1 Click the “person” icon at the top right next to the 3 dots.</p> <p>2 Click Turn on sync... and enter your LFDCS Google Account and Password.</p> <p><i>If you have a personal Google Account, you will see your existing profile instead, do the following:</i></p> <ul style="list-style-type: none">a) click +Add at the bottomb) type a name for your LFDCS Chrome profile, for example, “LFDCS”c) click SAVE at the bottom right. <p><i>You will then sign in with your LFDCS Google Account as above.</i></p>	

Steps Description

3. When Chrome data dialog window opens, read the disclaimer to understand how your data will be managed -- Click **Create a new profile**.

Follow the prompts to continue with the setup of your Chrome Profile and turn on sync.

You may Remove or delete your profile anytime you wish, your LFDCS Google Account data remain stored in your Google Account and can be managed on Google Dashboard.

Screenshots

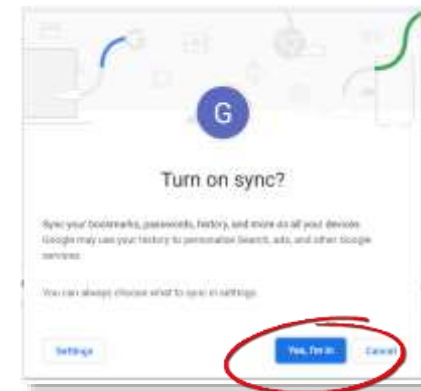
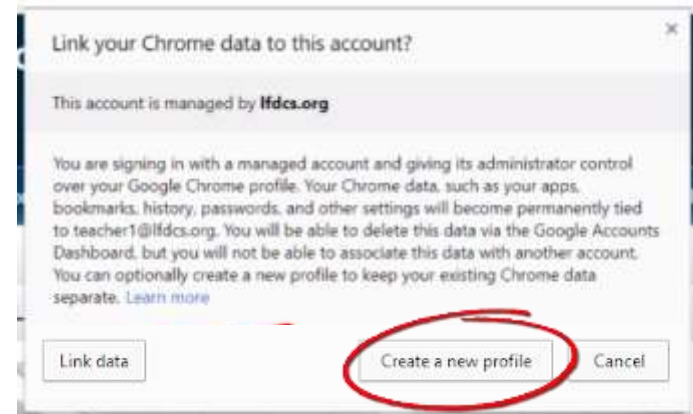

4. Once signed in, you will see the LFDCS folder with the district managed website links as well as the extensions, plugins, and settings to use all LFDCS instructional technology.

